





## Solair® Pro Retractable Awning

The Solair Pro is the ultimate solution for beautiful, stylish shade. Available in a wide range of fabrics, customizable sizes and modern frame color choices, the Pro will create a more finished, personalized look to your customers' outdoor oasis.

### Standard Features

**Frame:** Corrosion-resistant, electrostatic powder-coated aluminum.

**Arms:** Sturdy construction with self-lubricating middle hinge and upper arm attachment sleeve bushings to provide smooth, quiet operation and wear reduction. An elliptical cable path in the hinge allows for cables to hold tension in the arm springs for consistent operation and a tight fabric appearance.

**Hardware:** The Pro is manufactured with durable stainless steel, corrosion-resistant fasteners. Finished look with protective caps and covers to hide most exposed hardware.

**Pitch:** Adjustable locking awning pitch from 5° to 60° for maximum shade control.

**Performance:** Earned TUV Certification for its quality, durability and workmanship.

**Front Bar:** Extruded aluminum front bar engineered for long-lasting strength and durability. Front bar features a rain channel to prevent water from gathering. Dual action front bar attachment increases flexibility and reduces strain on arms during wind gusts.

**Roller Tube:** Galvanized steel roller tube provides greater strength and less deflection. (Use of a center support may still be recommended.)

### Styling

**Frame Colors:** White, Latte, Sand and Cocoa.

**Fabric Options:** Hundreds of fabric choices from Sunbrella® and Dickson® brands.

### Available Sizes

**Widths:** Custom 8 feet to 30 feet. All units greater than 25 feet wide will be spliced and shipped in two pieces requiring some field assembly before installation.

**Projections:** 5 feet, 6 feet 11 inches, 8 feet 7 inches, 10 feet 2 inches, 11 feet 6 inches and 13 feet.

### Motorized Operation

We recommend that the Solair Pro unit be motorized, for ease of use. We offer three standard RTS motor options based on the size of the unit (specifications listed on page #140). Hand held remote allows awning operation with the touch of a button from 65 feet away.

Some motors are available with a manual override option (CMO) for added safety in case of power loss.

Motorization also allows for additional electronic options such as wind and sun sensors (Somfy electronics covered on page #143).

### Optional Features

**Remote Control:** Allows awning operation with the touch of a button from up to 65 feet away (standard on motorized awnings).

**Protective Hood:** Protects fabric and motor while providing a finished look.

**Awning Assist Brace:** Removable brace engineered to add support and stability to any Solair retractable awning.

**Valance:** Choose from several styles – from traditional scalloped edges to modern straight lines.

**Valance Plus:** Screen or solid fabric unwinds from front valance to provide additional shade and privacy.

**Additional Information**

Solair XP Units allow for greater projections in narrower spaces. Ask a sales representative for more details.

Solair awnings can be mounted to the structural part of most buildings. Different types of brackets are required in certain applications. Contact your Trivantage sales representative or a Solair Technical Specialist for help in determining the best bracket for your application by calling 877.899.1680 or e-mailing us at: help@solair.com.

**The Installation Package Includes**

- Installed Motor
- Motor Bracket or Installation Kit for CMO Motors
- Crown
- Drive Wheel
- Switch and Plate (if standard motor)
- Switch Box and Power Cord (if plug-in motor)
- **Standard motor options include: (Extra cost varies)**
  - 1) Somfy 550 RTS – for units up to 24 feet when CMO is not required
  - 2) Sunea 550 RTS CMO – for units up to 24 feet when CMO is required
  - 3) Simu 660 RTS CMO – for units wider than 24 feet; CMO is standard
- **Remote Control Options: (Extra cost varies)**
  - 1) 274552 Single Channel Pure
  - 2) 274550 Four Channel Pure
  - 3) 274553 Single Channel Patio (weather resistant)
  - 4) 274551 Four Channel Patio (weather resistant)

**General Installation Requirements**

Installation manuals come standard with every awning. Please contact the Solair technical support team at 877.889.1680 with all installation questions.

The motor cable should not act as a direct conduit for water to enter the head of the motor. Note: Somfy motors conform to IP44 requirements and as such must be protected against direct weather elements such as rain, sleet, etc. In order to avoid water penetration, form a "drip loop" with the power cable and use a hood when required.

**RTS Motor Installation Requirements**

If the installation consists of multiple RTS motors, only one motor can be programmed at a time. All other motors must be disconnected. This will avoid interferences during the initial programming of each motor. The mounting distance between any two RTS motor heads should be no less than 19 inches to avoid possible interference.

<b>WARRANTY</b>	10-year limited warranty on Solair Pro framework. 10-year limited warranty on Sunbrella shade fabrics. 5-year limited warranty for specialty and decorative shade fabrics. 5-year warranty on Somfy motors. All warranties are good from the day of purchase. Complete warranties can be found online at Solair Shade Solutions Extranet.
-----------------	---

Solair®, Sunbrella® and Dickson® are registered trademarks of Glen Raven, Inc.  
Somfy® is a registered trademark of Somfy Systems, Inc.  
WireFree™ is a trademark of Somfy Systems, Inc.



**Solair® Pro Hood Kit**

Kits include new Solair Pro Hood, End Covers, and Hood Brackets in quantity appropriate for specified width.

**Available Sizes**

**Widths:** Hood kits are made to order from 8ft to 30ft wide. Orders over 24ft require splicing in the field.

**Available Colors**

- Cocoa
- Latte
- Sand
- White

Solair® is a registered trademark of Glen Raven, Inc.

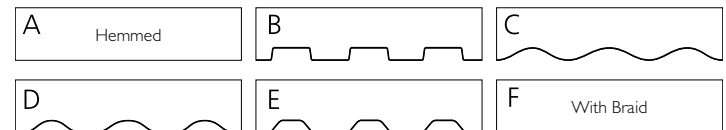

Standard Valance Styles

**Solair® Pro Awning Covers**

Save fabrication time! We offer quality covers for the Solair Pro. Covers are offered in any standard pattern of Sunbrella® and Dickson® awning fabric. (Other fabric styles upon request.) All Pro covers have welded seams unless otherwise noted.

Replacement covers and valances are available by special order. Please contact a Trivantage associate for details.

<b>WARRANTY</b>	10-year limited warranty on Solair Pro framework. 10-year limited warranty on Sunbrella shade fabrics. 5-year limited warranty for specialty and decorative shade fabrics. All warranties are good from the day of purchase. Complete warranties can be found online at Solair Shade Solutions Extranet.
-----------------	--

Solair®, Sunbrella® and Dickson® are registered trademarks of Glen Raven, Inc.



ITEM #	STYLE #	DESCRIPTION	COLOR
254136	RAL9010	0.6 oz. Brush Top Bottle	White
254137	RAL1019	0.6 oz. Brush Top Bottle	Latte
254138	RAL1013	0.6 oz. Brush Top Bottle	Sand
254139	RAL8017	0.6 oz. Brush Top Bottle	Cocoa

Solair® is a registered trademark of Glen Raven, Inc.

## Solair® Pro Components

ITEM #	DESCRIPTION	COLOR	MATERIAL	STANDARD PACKAGE
231916	Arm 10 ft. 2 in.	Cocoa		2
231716	Arm 10 ft. 2 in.	Latte		2
231816	Arm 10 ft. 2 in.	Sand		2
231616	Arm 10 ft. 2 in.	White		2
231917	Arm 11 ft. 6 in.	Cocoa		2
231717	Arm 11 ft. 6 in.	Latte		2
231817	Arm 11 ft. 6 in.	Sand		2
231617	Arm 11 ft. 6 in.	White		2
231918	Arm 13 ft.	Cocoa		2
231718	Arm 13 ft.	Latte		2
231818	Arm 13 ft.	Sand		2
231618	Arm 13 ft.	White		2
231913	Arm 5 ft.	Cocoa		2
231713	Arm 5 ft.	Latte		2
231813	Arm 5 ft.	Sand		2
231613	Arm 5 ft.	White		2
231914	Arm 6 ft. 11 in.	Cocoa		2
231714	Arm 6 ft. 11 in.	Latte		2
231814	Arm 6 ft. 11 in.	Sand		2
231614	Arm 6 ft. 11 in.	White		2
231915	Arm 8 ft. 7 in.	Cocoa		2
231715	Arm 8 ft. 7 in.	Latte		2
231815	Arm 8 ft. 7 in.	Sand		2
231615	Arm 8 ft. 7 in.	White		2
231697	Beam Bracket	White	Powder Coated Steel	1
231902	Center Support	Cocoa		1
231702	Center Support	Latte		1
231802	Center Support	Sand		1
231602	Center Support	White		1
231904	Conical Gear 4.4:1	Cocoa		1
231704	Conical Gear 4.4:1	Latte		1
231804	Conical Gear 4.4:1	Sand		1
231604	Conical Gear 4.4:1	White		1
231986	Front Bar 16 ft.	Cocoa	Extruded Aluminum	1
231786	Front Bar 16 ft.	Latte	Extruded Aluminum	1
231886	Front Bar 16 ft.	Sand	Extruded Aluminum	1
231686	Front Bar 16 ft.	White	Extruded Aluminum	1
231987	Front Bar 20 ft.	Cocoa	Extruded Aluminum	1
231787	Front Bar 20 ft.	Latte	Extruded Aluminum	1
231887	Front Bar 20 ft.	Sand	Extruded Aluminum	1
231687	Front Bar 20 ft.	White	Extruded Aluminum	1

## Solair® Pro Valance Plus System

The Solair Pro Valance Plus System is a vertical roll-down drop valance option that provides protection from the setting sun. A standard 4-foot vertical fabric drop from the front bar is optimal for western exposures.

The Valance Plus System consists of a cassette and a drop valance fabric (valance fabric sold separately). The design of the cassette also accommodates a standard fixed valance. The Valance Plus cassette is available in white, latte, sand and cocoa frame colors. The system is only available for the Pro unit with projections up to 10ft 2in and widths up to 20ft. Allow for additional delivery time.

WARRANTY	
	10-year limited warranty on Solair Pro Valance Plus framework. Fabric warranties will vary but most have 5 or 10 year limited warranties.

Solair® is a registered trademark of Glen Raven, Inc.

## Solair® Pro Valance Plus Fabric

Solair Pro Valance Plus Fabric is supplied for use in the Solair Pro Valance Plus System. The fabric is available in widths from 10 feet to 20 feet, with a standard drop of four feet. Choose from a selection of 60 inch Sunbrella® solids, or select a Sunbrella pattern that coordinates with your awning cover fabric. Also available in 90% Textilene® in five stock colors (Black, Brown, Beige, Grey and Desert Sand).

Solair® and Sunbrella® are registered trademarks of Glen Raven, Inc. Textilene® is a registered trademark of Twitchell Corporation.

## Solair® Touch-Up Paint

A lacquer base, touch-up paint for Solair. Ideal for touching up small areas.

ITEM #	STYLE #	DESCRIPTION	COLOR
254130	RAL9010	12 oz. Aerosol Can	White
254131	RAL9019	12 oz. Aerosol Can	Latte
254132	RAL1013	12 oz. Aerosol Can	Sand
254133	RAL8017	12 oz. Aerosol Can	Cocoa

ITEM #	DESCRIPTION	COLOR	MATERIAL	STANDARD PACKAGE
231988	Front Bar 24 ft.	Cocoa	Extruded Aluminum	1
231788	Front Bar 24 ft.	Latte	Extruded Aluminum	1
231888	Front Bar 24 ft.	Sand	Extruded Aluminum	1
231688	Front Bar 24 ft.	White	Extruded Aluminum	1
231908	Front Bar Attachment	Cocoa		2
231708	Front Bar Attachment	Latte		2
231808	Front Bar Attachment	Sand		2
231608	Front Bar Attachment	White		2
231909	Front Bar End Cap	Cocoa	Plastic	2
231709	Front Bar End Cap	Latte	Plastic	2
231809	Front Bar End Cap	Sand	Plastic	2
231609	Front Bar End Cap	White	Plastic	2
231990	Hood 16 ft.	Cocoa	Aluminum	1
231790	Hood 16 ft.	Latte	Aluminum	1
231890	Hood 16 ft.	Sand	Aluminum	1
231690	Hood 16 ft.	White	Aluminum	1
231991	Hood 20 ft.	Cocoa	Aluminum	1
231791	Hood 20 ft.	Latte	Aluminum	1
231891	Hood 20 ft.	Sand	Aluminum	1
231691	Hood 20 ft.	White	Aluminum	1
231992	Hood 24 ft.	Cocoa	Aluminum	1
231792	Hood 24 ft.	Latte	Aluminum	1
231892	Hood 24 ft.	Sand	Aluminum	1
231692	Hood 24 ft.	White	Aluminum	1
231657	Hood Bracket	Cocoa	Extruded Aluminum	2
231655	Hood Bracket	Latte	Extruded Aluminum	2
231656	Hood Bracket	Sand	Extruded Aluminum	2
231654	Hood Bracket	White	Extruded Aluminum	2
231920	Hood End Cap	Cocoa	Aluminum	2
231720	Hood End Cap	Latte	Aluminum	2
231820	Hood End Cap	Sand	Aluminum	2
231620	Hood End Cap	White	Aluminum	2
231905	Retention Pin	Cocoa	Nylon	2
231705	Retention Pin	Latte	Nylon	2
231805	Retention Pin	Sand	Nylon	2
231605	Retention Pin	White	Nylon	2
231500	Roller Tube 16 ft x 78 mm		Galvanized Steel	1
270255	Roller Tube 16 ft. x 80 mm		Aluminum	1
231501	Roller Tube 20 ft. x 78 mm		Galvanized Steel	1
270256	Roller Tube 20 ft. x 80 mm		Aluminum	1
231502	Roller Tube 24 ft. x 78 mm		Galvanized Steel	1
270257	Roller Tube 24 ft. x 80 mm		Aluminum	1

ITEM #	DESCRIPTION	COLOR	MATERIAL	STANDARD PACKAGE
231503	Roller Tube 30 ft. x 78 mm		Galvanized Steel	1
231901	Roller Tube Support Bracket Set with Covers	Cocoa	Extruded Aluminum, Plastic	2
231701	Roller Tube Support Bracket Set with Covers	Latte	Extruded Aluminum, Plastic	2
231801	Roller Tube Support Bracket Set with Covers	Sand	Extruded Aluminum, Plastic	2
231601	Roller Tube Support Bracket Set with Covers	White	Extruded Aluminum, Plastic	2
231508	Round Gudgeon 80 mm		Plastic	1
231907	Shoulder for 13 ft. Arms	Cocoa		2
231707	Shoulder for 13 ft. Arms	Latte		2
231807	Shoulder for 13 ft. Arms	Sand		2
231607	Shoulder for 13 ft. Arms	White		2
231906	Shoulder for up to 11 ft. 6 in. Arms	Cocoa		2
231706	Shoulder for up to 11 ft. 6 in. Arms	Latte		2
231806	Shoulder for up to 11 ft. 6 in. Arms	Sand		2
231606	Shoulder for up to 11 ft. 6 in. Arms	White		2
231921	Soffit Bracket Adapter	Cocoa	Extruded Aluminum	2
231721	Soffit Bracket Adapter	Latte	Extruded Aluminum	2
231821	Soffit Bracket Adapter	Sand	Extruded Aluminum	2
231621	Soffit Bracket Adapter	White	Extruded Aluminum	2
231982	Torsion Bar 16 ft.	Cocoa	Aluminum	1
231782	Torsion Bar 16 ft.	Latte	Aluminum	1
231882	Torsion Bar 16 ft.	Sand	Aluminum	1
231682	Torsion Bar 16 ft.	White	Aluminum	1
231983	Torsion Bar 20 ft.	Cocoa	Aluminum	1
231783	Torsion Bar 20 ft.	Latte	Aluminum	1
231883	Torsion Bar 20 ft.	Sand	Aluminum	1
231683	Torsion Bar 20 ft.	White	Aluminum	1
231984	Torsion Bar 24 ft.	Cocoa	Aluminum	1
231784	Torsion Bar 24 ft.	Latte	Aluminum	1
231884	Torsion Bar 24 ft.	Sand	Aluminum	1
231684	Torsion Bar 24 ft.	White	Aluminum	1
231653	Wall Bracket	Cocoa	Extruded Aluminum	2
231651	Wall Bracket	Latte	Extruded Aluminum	2
231652	Wall Bracket	Sand	Extruded Aluminum	2
231650	Wall Bracket	White	Extruded Aluminum	1
231923	XP System	Cocoa		2
231723	XP System	Latte		2
231823	XP System	Sand		2
231623	XP System	White		2

For ordering assistance, contact Trivantage customer service at 800.786.1876 or visit the online Solair Shade Solutions Extranet for order forms and pricing.



## Solair® Comfort Retractable Awning

Add a new room to their house.

Your customers can enjoy their outdoor spaces like never before with Solair Comfort. They'll sit in cool comfort or bask in the sun with this easy-to-use, retractable awning. Add beauty to their home. Reduce their energy bills and protect their furniture against harmful UV rays. It's all possible with this affordable shade solution from the shade experts.

### Standard Features

**Frame:** All aluminum frame components are electrostatic powder coated to provide a corrosion-resistant, high quality finish.

**Arms:** Arm control features double galvanized steel cables, wrapped in PVC for corrosion resistance and long life.

**Hardware:** Durable, die-cast arm construction.

**Performance:** Earned TUV Certification for its quality, durability and workmanship.

**Front Bar:** Front bar attachment has dual-action feature that increases flexibility and reduces strain on the awning during a wind gust.

### Styling

**Frame Colors:** White and Latte.

**Fabric Options:** Hundreds of fabric choices from Sunbrella® and Dickson® brands.

### Available Sizes

**Widths:** 11 feet 9 inches, 15 feet 6 inches, 19 feet 3 inches.

**Projection:** 10 feet 2 inches.

### Motorized Operation

Optional motorized operation available and recommended for ease of use. Hand held remote included with motorized option. Allows awning operation with the touch of a button from 65 feet away.

### Optional Features

**Wireless Wind Sensor:** Automatically retracts awnings upon detection of damaging winds.

**Awning Assist Brace:** Removable brace engineered to add support and stability to any Solair retractable awning.

**Protective Hood:** Protects fabric and motor while providing a finished look.

### WARRANTY

10-year limited warranty on Sunbrella shade fabrics. 5-year limited warranty for specialty and decorative shade fabrics. 5-year warranty on Somfy motors. All warranties are good from the day of purchase. Complete warranties can be found online at Solair Shade Solutions Extranet.

Solair®, Sunbrella® and Dickson® are registered trademarks of Glen Raven, Inc.

## Solair® Comfort Hood Kit

ITEM #	COLOR	STANDARD PACKAGE	WIDTH
276255	Latte	1	11 ft. 9 in.
276256	Latte	1	15 ft. 6 in.
276257	Latte	1	19 ft. 3 in.
276252	White	1	11 ft. 9 in.
276253	White	1	15 ft. 6 in.
276254	White	1	19 ft. 3 in.

Solair® is a registered trademark of Glen Raven, Inc.



231612

## Solair® Comfort Components

ITEM #	DESCRIPTION	COLOR	STANDARD PACKAGE
231751	Arm 10 ft. 2 in.	Latte	1
231627	Arm 10 ft. 2 in.	White	1
275336	Beam Bracket		1
231752	Front Bar Attachment	Latte	1
231628	Front Bar Attachment	White	1
231753	Front Bar End Cap	Latte	1
231629	Front Bar End Cap	White	1
231755	Hood Bracket	Latte	1
231756	Hood Bracket	White	1
231758	Hood End Cap	Latte	1
231757	Hood End Cap	White	1
231750	Shoulder	Latte	1
231612	Shoulder	White	1
231754	Wall Bracket	Latte	1
231597	Wall Bracket	White	1

## Solair® Accessories

ITEM #	DESCRIPTION	COLOR	MATERIAL	STANDARD PACKAGE
299545	Awning Assist Brace Kit	White		1
106805	Hand Brace 24 in.		Aluminum w/Wooden Handle	1
106800	Hand Brace 57 in.		Aluminum w/Wooden Handle	1
106801	Hand Brace 65 in.		Aluminum w/Wooden Handle	1
106802	Hand Brace 77 in.		Aluminum w/Wooden Handle	1
106803	Hand Brace 97 in.		Aluminum w/Wooden Handle	1
270399	Lock Fabric with Stainless Steel Screw			1
231696	Roof Mount Bracket 10 in.		Stainless Steel	1
231622	Roof Mount Bracket 12 in.		Stainless Steel	1
269869	Roof Mount Bracket 9 in.		Stainless Steel	1
225206	Spacer 1.75 in. x 0.50 in. Thick			1
225207	Spacer 1.75 in. x 0.75 in. Thick			1
225208	Spacer 1.75 in. x 1 in. Thick			1

Solair® is a registered trademark of Glen Raven, Inc.

## Solair® Touch-Up Paint

A lacquer base, touch-up paint for Solair. Ideal for touching up small areas.

ITEM #	STYLE #	DESCRIPTION	COLOR	STANDARD PACKAGE
254139	RAL8017	0.6 oz. Brush Top Bottle	Cocoa	1
254137	RAL1019	0.6 oz. Brush Top Bottle	Latte	1
254138	RAL1013	0.6 oz. Brush Top Bottle	Sand	1
254136	RAL9010	0.6 oz. Brush Top Bottle	White	1
254133	RAL8017	12 oz. Aerosol Can	Cocoa	1
254131	RAL9019	12 oz. Aerosol Can	Latte	1
254132	RAL1013	12 oz. Aerosol Can	Sand	1
254130	RAL9010	12 oz. Aerosol Can	White	1

Solair® is a registered trademark of Glen Raven, Inc.



## Solair® Power Screen

Revamp your customer's space with the click of a button so they can enjoy the outdoors on their terms. The Solair Power Screen transforms residential and commercial outdoor spaces into comfortable, ventilated, pest-free environments, protected from harmful UV rays. Motorized or manually operated, each Solair Power Screen is custom-designed and fabricated to fit the shape and design of the structure. When not in use, the screen retracts out-of-sight and blends stylishly with the building's exterior.

The SRS (Side Retention System) Power Screen is widely known as the highest performing screen system on the market today. The key to the superior functionality of the SRS is its fully retained fabric inside of aluminum side rails. The design creates a tight fit and long lasting performance.

With the increase in popularity of clear vinyl and fabric enclosures utilizing the Power Screen SRS, there are added precautions that you need to be aware of. When these screens are deployed, it is imperative someone observes the deployment of each screen (we do not recommend putting more than one screen per channel on a remote control). Operation in conditions in which wind and/or cold temperatures are present can result in the screen encountering a stall. Please consult your Trivantage sales representative on all clear vinyl and fabric enclosures.

Specially designed housing cassettes in two sizes allow product widths from 4ft to 18ft, and drops from 3ft to 11ft. Additional sizes may be available if needed. Consult your sales associate for additional information.

Offered in a variety of screening and shading options to suit your customer's needs.

When lowered in the summer months, Solair Power Screen fabrics will reduce air conditioning costs.

During cooler weather, the Solair Power Screen can be kept open to allow the sun's warmth to penetrate the interior.

Utilizing the latest technology, many Solair Power Screen fabrics are not only fire retardant, but industry leaders in puncture, tear and mildew resistance. Manufactured with the highest grade aluminum and nylon components, Solair Power Screens stand up to the toughest environments.

Power Screen frames are available in eleven colors: Black, Bronze, Brown, Desert Sand, Gray, Green, Tan, Navajo, Silver, White, Bright White. Custom colors are available at additional cost.

Motorized operation is recommended for all screen installations for quick deployment or retraction when needed. Motors offered are matched to the torque required based on fabric and frame weight.

---

**WARRANTY** 10-year limited frame warranty. Proper installation techniques must be followed to ensure long-term performance. Improper installation techniques will void warranty. Please consult your sales representative for installation guidelines.

---

Solair® is a registered trademark of Glen Raven, Inc.





## Solair® Cable Curtain

Your customer can enjoy more time outdoors with the privacy and shade of the Solair Cable Curtain. When used as window shades, cable curtains can help reduce cooling costs and keep the heat outside the home. Perfect for both residential and commercial applications such as patios, gazebos and storefront settings.

Similar to the vertical curtain, the cable curtain includes a bottom bar, which connects to your choice of either 10 foot or 15 foot stainless steel side cables. The cables are supplied with cable clamps for securing cables to the floor or wall.

### Standard Features

**Frame:** Made with electrostatic powder coated aluminum and galvanized steel components for a strong but light weight unit.

**Winding Brace:** Available in 24 inch, 57 inch, 65 inch (standard), 77 inch, or 97 inch.

### Styling

**Frame Colors:** White, Sand and Cocoa.

### Available Sizes

Frame kits are available in widths from 4 feet to 20 feet.

### Motorized Operation

Optional motorized operation available and recommended for ease of use.

### Optional Features

**Remote Control:** Allows you to operate curtain with the touch of a button from up to 65 feet away.

**Protective Hood:** Protects fabric and motor while providing a finished look.

**WARRANTY**      Frame: 5-year warranty  
                          Motor: 5-year warranty

Solair® is a registered trademark of Glen Raven, Inc.



## Solair® Vertical Curtain

The Solair Vertical Curtain provides an economical way to offer your customers a retractable vertical shade. These shades can reduce cooling costs and keep the heat outside the home. Perfect for both residential and commercial applications such as patios, gazebos and storefront settings. The system includes roller tube, gear, winding brace and mounting hardware.

### Standard Features

**Frame:** Made with electrostatic powder coated aluminum and galvanized steel components for a strong but light weight unit.

**Winding Brace:** Available in 24 inch, 57 inch, 65 inch (standard), 77 inch, or 97 inch.

### Styling

**Frame Colors:** White, Sand and Cocoa.

### Available Sizes

Frame kits are available in widths from 4 feet to 20 feet.

### Motorized Operation

Optional motorized operation available and recommended for ease of use.

### Optional Features

**Remote Control:** Allows you to operate curtain with the touch of a button from up to 65 feet away.

**Protective Hood:** Protects fabric and motor while providing a finished look.

**WARRANTY**      Frame: 5-year warranty  
                          Motor: 5-year warranty



## Solair® Cable And Vertical Curtain Components

ITEM #	DESCRIPTION	COLOR	MATERIAL	STANDARD PACKAGE
231945	Bottom Bar 19 ft. 8 in.	Cocoa	Powder Coated Aluminum	1
231745	Bottom Bar 19 ft. 8 in.	Latte	Powder Coated Aluminum	1
231845	Bottom Bar 19 ft. 8 in.	Sand	Powder Coated Aluminum	1
231645	Bottom Bar 19 ft. 8 in.	White	Powder Coated Aluminum	1
231523	Bottom Bar Gudgeon	Black	Synthetic	1
231521	Cables 10 ft.		Stainless Steel	2
231522	Cables 15 ft.		Stainless Steel	2
231524	Curtain Cap with Lock 1.57" for 0.16 Cable			1
231940	Curtain Feet	Cocoa	Powder Coated Aluminum	2
231740	Curtain Feet	Latte	Powder Coated Aluminum	2
231840	Curtain Feet	Sand	Powder Coated Aluminum	2
231640	Curtain Feet	White	Powder Coated Aluminum	2
231939	End Bracket	Cocoa	Powder Coated Aluminum	2
231739	End Bracket	Latte	Powder Coated Aluminum	2
231839	End Bracket	Sand	Powder Coated Aluminum	2
231639	End Bracket	White	Powder Coated Aluminum	2
231937	End Brackets	Cocoa	Powder Coated Aluminum	2
231837	End Brackets	Sand	Powder Coated Aluminum	2
231637	End Brackets	White	Powder Coated Aluminum	2
231903	Gear 9:1	Cocoa		1
231803	Gear 9:1	Sand		1
231603	Gear 9:1	White		1
231944	Hood 20 ft.	Cocoa	Aluminum	1
231844	Hood 20 ft.	Sand	Aluminum	1
231644	Hood 20 ft.	White	Aluminum	1
231942	Hood Bracket	Cocoa	Powder Coated Steel	2
231842	Hood Bracket	Sand	Powder Coated Steel	2
231642	Hood Bracket	White	Powder Coated Steel	2
231943	Hood End Cap	Cocoa	Aluminum	2
231843	Hood End Cap	Sand	Aluminum	2
231643	Hood End Cap	White	Aluminum	2
231519	Pin Set			1
231518	Pinless Round Gudgeon 80 mm	Grey	Plastic	1
231507	Square Gudgeon 80 mm	Grey	Plastic	1

## Solair® Patio Screens

Enjoy your outdoor space more often with a Solair Patio Screen. This economical vertical drop screen blocks wind and rain, eliminates glare and reduces radiant heat inside and outside of your home. Available in four frame colors and several screen options, this is the perfect shade and privacy solution for gazebos, pergolas, outdoor kitchens and many other outdoor living spaces.

The Solair Patio Screen can be used to reduce glare inside homes and buildings. The Solair Patio Screen with cable kit is recommended where light winds are common.

### Standard Features

**Frame:** Made with two aluminum mounting brackets and galvanized steel roller tube and decorative aluminum weighted hem bar.

### Styling

**Frame Colors:** White, Sand, Cocoa and Latte.

### Available Sizes

Manufactured to the inch in widths ranging from 3' to 15' and drops from 3' to 15'.

### Motorized Operation

Optional motorized operation available and recommended for ease of use.

### Optional Features

**Remote Control:** Allows you to operate curtain with the touch of a button from up to 65 feet away.

**Protective Hood:** Protects fabric and motor while providing a finished look.

**WARRANTY** Frame: 5-year warranty  
Motor: 5-year warranty

Solair® is a registered trademark of Glen Raven, Inc.



## Solair® Maxi Window Awning

Make your customer’s home cooler and more stylish. The Solair window awning is a great investment in the beauty and value of a home or business. Adding a customized look to the outside, these shade solutions work to control the temperature and protect furniture and flooring against sun damage inside. Solair window awnings feature your choice of hundreds of fade-resistant and easy-to-clean fabrics, including brands like Sunbrella® and Dickson®, to customize any style of home. And thanks to design-inspired engineering using the highest quality materials and components, you will enjoy these shade solutions with little maintenance required.

The Solair Maxi window awning is recommended for use over large window spans where durability and strength are required. Available in four stock arm projections (2ft. 4in./ 3ft. 4in./ 4ft. 6in./ 5ft. 8in.) and made to order in custom widths from 6ft. to 20ft. Frame colors include white, sand and cocoa.

<b>WARRANTY</b>	5-year limited warranty on Solair Maxi framework. 10-year limited warranty on Sunbrella shade fabrics. 5-year limited warranty for specialty and decorative shade fabrics. 5-year warranty on Somfy motors. All warranties are good from the day of purchase. Complete warranties can be found online at Solair Shade Solutions Extranet.
-----------------	---

Solair®, Sunbrella® and Dickson® are registered trademarks of Glen Raven, Inc. Somfy® is a registered trademark of Somfy Systems, Inc.

## Solair® Maxi Hood Kit

Kits include Maxi Hood, End Covers and Hood Brackets in quantity appropriate for specified kit width.

### Available Sizes

**Widths:** Maxi Hood kits are made to order from 8ft to 20ft wide.

### Available Colors

Cocoa

Sand

White

Solair® is a registered trademark of Glen Raven, Inc.

## Solair® Maxi Awning Covers

Save fabrication time! We offer quality covers for the Solair Maxi window shade systems. Covers are offered in any standard pattern of Sunbrella® and Dickson® awning fabric. (Other fabric styles upon request.) Available with welded seams.

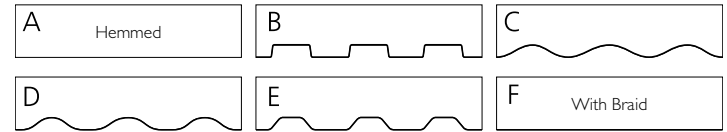

Solair®, Sunbrella® and Dickson® are registered trademarks of Glen Raven, Inc.

## Solair® Maxi Components

ITEM #	DESCRIPTION	COLOR	MATERIAL	STANDARD PACKAGE
341742	Arm 2 ft. 4 in.	Cocoa		2
341762	Arm 2 ft. 4 in.	Latte		2
341722	Arm 2 ft. 4 in.	Sand		2
341743	Arm 3 ft. 4 in.	Cocoa		2
341763	Arm 3 ft. 4 in.	Latte		2
341723	Arm 3 ft. 4 in.	Sand		2
341703	Arm 3 ft. 4 in.	White		2
341744	Arm 4 ft. 6 in.	Cocoa		2
341764	Arm 4 ft. 6 in.	Latte		2
341724	Arm 4 ft. 6 in.	Sand		2
341704	Arm 4 ft. 6 in.	White		2
341745	Arm 5 ft. 8 in.	Cocoa		2
341765	Arm 5 ft. 8 in.	Latte		2
341725	Arm 5 ft. 8 in.	Sand		2
341705	Arm 5 ft. 8 in.	White		2
341750	End Bracket	Cocoa	Aluminum Die Cast	2
341770	End Bracket	Latte	Aluminum Die Cast	2
341730	End Bracket	Sand	Aluminum Die Cast	2
341710	End Bracket	White	Aluminum Die Cast	2
341752	Front Bar Ends Caps	Cocoa	Plastic	2
341772	Front Bar Ends Caps	Latte	Plastic	2
341732	Front Bar Ends Caps	Sand	Plastic	2
341712	Front Bar Ends Caps	White	Plastic	2
341749	Gear 9:1	Cocoa		1
341769	Gear 9:1	Latte		1
341729	Gear 9:1	Sand		1
341709	Gear 9:1	White		1
341755	Hood 22 ft.	Cocoa	Aluminum	1
341775	Hood 22 ft.	Latte	Aluminum	1
341735	Hood 22 ft.	Sand	Aluminum	1
341715	Hood 22 ft.	White	Aluminum	1
341753	Hood Bracket	Cocoa	Powder Coated Steel	2
341773	Hood Bracket	Latte	Powder Coated Steel	2
341733	Hood Bracket	Sand	Powder Coated Steel	2
341713	Hood Bracket	White	Powder Coated Steel	2
341754	Hood End Cap	Cocoa	Aluminum	2
341774	Hood End Cap	Latte	Aluminum	2

ITEM #	DESCRIPTION	COLOR	MATERIAL	STANDARD PACKAGE
341734	Hood End Cap	Sand	Aluminum	2
341714	Hood End Cap	White	Aluminum	2

Solair® is a registered trademark of Glen Raven, Inc.



## Somfy® Operators and Operator Options

These high-quality tubular motors and remote controls are designed to operate all Solair retractable awning systems. They provide the ultimate convenience in retractable awning operation. A remote control receiver is incorporated within the motor allowing the user remote control capability (no more electricians to hardwire the electronics). The receivers have a range up to 65 feet. All motors come standard with a power cord. Multiple lengths are available.

### General Installation Requirements

The motor cable should not act as a direct conduit for water to enter the head of the motor. Note: Somfy motors conform to IP44 requirements and as such must be protected against direct weather elements such as rain, sleet, etc. In order to avoid water penetration, form a "drip loop" with the power cable and use a hood when required.

### RTS Motor Installation Requirements

If the installation consists of multiple RTS motors, only one motor can be programmed at a time. All other motors must be disconnected. This will avoid interferences during the initial programming of each motor. The mounting distance between any two RTS motor heads should be no less than 19 inches, to avoid possible interference.

Use only Somfy RTS radio controls.

<b>WARRANTY</b>	5-Year
-----------------	--------

ITEM #	STYLE #	DESCRIPTION	COLOR	STANDARD PACKAGE
274499	1810639	1-Channel Transmitter	Silver	1
276645	1810650	Telis 1-Channel RTS Lounge Transmitter		1
274553	1810643	Telis 1-Channel RTS Patio Transmitter	Blue/White	1
274552	1810632	Telis 1-Channel RTS Pure Transmitter		1
276650	1811082	Telis 16-Channel RTS Transmitter	Silver	1
275019	1810652	Telis 4 5-Channel RTS Lounge Transmitter		1
274551	1810645	Telis 4 5-Channel RTS Patio Transmitter	Blue/White	1
274550	1810633	Telis 4 5-Channel RTS Pure Transmitter		1
274498	1810641	Telis 4 5-Channel Transmitter	Silver	1
274571	1811243	Telis Soliris 4 5-Channel RTS Patio Transmitter	Blue/White	1
274547	1810635	Telis Soliris RTS Pure Transmitter		1

Somfy® is a registered trademark of Somfy Systems, Inc.

## Somfy® Altus RTS Motor

<b>WARRANTY</b>	5-Year
-----------------	--------

ITEM #	STYLE #	DESCRIPTION	CABLE CORD LENGTH	STANDARD PACKAGE
274753	1043287	RTS Motor 525A2 LT50 with NEMA Plug	12 ft.	1
274751	1037501	RTS Motor 525S2 with NEMA Plug		1
274761	1037511	RTS Motor 550R2 with NEMA Plug	12 ft.	1
274031	9012145	RTS Motor Cable with NEMA Plug	12 ft.	1
274304	9012151	RTS Motor Cable with NEMA Plug	18 ft.	1
274006	9012146	RTS Motor Cable with NEMA Plug	24 ft.	1

Somfy® is a registered trademark of Somfy Systems, Inc.

# SUNEA RTS CMO VISUAL REFERENCE GUIDE

## STANDARD AWNING SETTINGS:

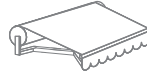

Both UP and DOWN limits need to be set.

**Before You Begin:**

Make sure the DOWN button on the remote extends the awning. (▼ = awning moves outward or extends). Failure to correct this may cause damage to the awning or personal injury.

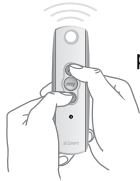

**STEP 1**

Initiate programming by pressing both the ▲ (Up) and ▼ (Down) buttons at the same time until the motor jogs.



**STEP 2**

Check the direction of operation. Press and hold the ▼ button and confirm it moves the motor out. To change the direction press and hold the my (Stop) button until the motor jogs.

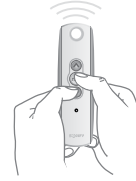

**STEP 3**

Bring the motor to your desired upper limit by pressing the ▲ button. Press and hold both the my and ▼ buttons until the motor begins to move down, then release. Use the my button to stop it at the desired lower limit

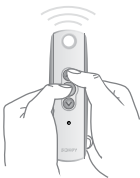

**STEP 4**

Press the my and ▲ button until the motor begins to move up. the motor will stop at the original upper point.



**STEP 5**

Press and hold the my button until the motor jogs



**STEP 6**

Press and hold the Program button on the back of the transmitter until the motor jogs. Double check limits as a precaution.

## ADJUSTING THE LIMITS

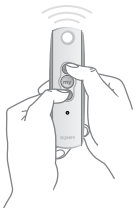

To change the lower limit:

Move the motor to its current lower limit position and let it stop. Press and hold the ▲ and ▼ buttons simultaneously until the motor jogs, then release. Adjust to a new lower limit position. Press the my button until the motor jogs, then release. Check new limit.

To change the upper limit:

Move the motor to its current upper limit position and let it stop. Press and hold the ▲ and ▼ buttons simultaneously until the motor jogs, then release. Adjust to a new upper limit position. Press the my button until the motor jogs, then release. Check new limit.

To add a remote/channel or sun and wind sensor:

First press the programming button on the back of the already programmed remote until the motor jogs. Then press the programming button on the remote or sun/wind sensor that you would like to add until the motor jogs. Check it.



To reset the motor:

you will need to disconnect power (120vac) for 2 seconds, reconnect for 10 seconds, disconnect for another 2 seconds and reconnect. The motor should start to move or jog (If this does not happen, continue to perform the disconnects until it does). Once the motor stops, press and hold the programming button on the back of the remote and count to ten without letting go. The motor should jog twice.

## ADVANCED FEATURE FUNCTIONS

### BACK IMPULSE function for both cassette and standard awnings

This function allows you to apply tension on the fabric when the awning is fully extended. The motor can be adjusted up to a ½ half turn.

**STEP 1**  
Disconnect power momentarily and reconnect.

**STEP 2**  
Set the awning to the lowest position.



**STEP 3**  
Press the MY and Up buttons until the awning jogs: The motor is in programming mode.



**STEP 4**  
Adjust the fabric's tension using the Up or Down buttons.



**STEP 5**  
Press the MY button until the awning jogs: The fabric's tension has been programmed.



SOMFY SYSTEMS, INC.  
1-800-22SOMFY

SOMFY CANADA  
1-905-564-6446

WWW.SOMFYSYSTEMS.COM

L-0138





Somfy Sunea RTS CMO Motor with Extension Cord with NEMA Plug

### Somfy® Sunea RTS CMO Motor

The Sunea RTS CMO motor, which is used most often in our Solair Pro retractable awning, features easy limit-setting via transmitter, torque sensing capabilities, back release function, back impulse function setting, manual override, built-in Radio Technology Somfy (RTS), and a convenient 18 inch fast connector cable to adapt to various cable lengths. The Sunea RTS CMO is compatible with Somfy's entire collection of RTS controls including hand-held remotes, wall switches, timers, sensors and outdoor heaters.

WARRANTY		5-Year		
ITEM #	STYLE #	DESCRIPTION	CABLE CORD LENGTH	STANDARD PACKAGE
274577	9015977	RTS CMO Extension Cord with NEMA Plug	18 ft.	1
274578	9015784	RTS CMO Extension Cord with NEMA Plug	24 ft.	1
274576	9015783	RTS CMO Extension Cord with NEMA Plug	12 ft.	1
273920	1114230	RTS CMO Motor 525A2		1
273922	1118167	RTS CMO Motor 550R2		1
274580	9015989	RTS CMO Override Kit		1

Somfy® is a registered trademark of Somfy Systems, Inc.

### Somfy® CMO Motor

The Somfy Compact Manual Override (CMO) Motor provides an added safety feature in the event of a power failure. Anyone can easily operate the crank handle as the reduction ratio allows for quick and easy operation. With the new rapid limit switch, all that is required to set the length of travel is a simple touch adjustment.

#### Features

Compact Design: Requires minimum installation space (1.0 in. – 24 mm).

Ease of Operation: Minimum effort required for crank operation.

Tested Reliability: Meets UL and CSA standards.

WARRANTY		5-Year		
ITEM #	STYLE #	DESCRIPTION	CABLE CORD LENGTH	STANDARD PACKAGE
274126	9012349	CMO Motor Override Kit (Metric)		1
274131	9685114	CMO Motor Override Shaft 60 mm		1
273942	9077287	CMO Motor Override Shaft with Eye 100 mm		1
274740		RTS CMO Motor 525A2 with NEMA Plug	12 ft.	1
274032	9012148	RTS CMO Motor Cable with NEMA Plug	12 ft.	1
274122	9012149	RTS CMO Motor Cable with NEMA Plug	24 ft.	1
274306	9012150	RTS CMO Motor Cable with NEMA Plug	18 ft.	1

Somfy® is a registered trademark of Somfy Systems, Inc.

### Somfy® Motor Hardware

WARRANTY		5-Year		
ITEM #	STYLE #	DESCRIPTION		STANDARD PACKAGE
270531	9707027	Crown for LT50 DS78		1
270547	9707639	Crown for LT60 DS78/D		1
273971	9012241	Drive Mod DS78		1
273968	9910001	Universal Bracket with Spring Ring (Metric)		1

Somfy® is a registered trademark of Somfy Systems, Inc.



## SIMU® Solar AutoSun™ Solar Power Operator

The AutoSun Motor System from Simu uses the power of the sun to effortlessly retract Solair window awnings, roller shutters, screens, awning front valances and RV awnings.

By tapping the power of the sun, the AutoSun system uses only clean, renewable and free energy. First, the system collects solar energy through its solar panel. Then, the energy is transmitted from the solar panel to a battery. The DC motor is then powered by the battery and is controlled by an integrated SIMU-Hz radio control and electronic limits.

Using advanced technology, this solar powered system also detects frost and obstacles for worry free operation when mounted in rolling shutters. AutoSun is also quick and easy to install. It requires no power supply cables, no holes to be drilled and no electrician is necessary.

Operation is simple. The battery features an easy access button to reset the motor. And thanks to built in radio technology, the end limit distance settings can be personalized with four different possibilities using the remote.

WARRANTY		5-Year	
ITEM #	STYLE #	DESCRIPTION	STANDARD PACKAGE
276651	2007000	AutoSun 10Nm Motor System	1
274557	9014734	AutoSun Battery	1
274558	2006996	AutoSun Motor System	1

SIMU® is a registered trademark of SIMU France.

## Somfy® Ondeis™ WireFree RTS Rain and Sun Sensor

The Ondeis Wirefree sensor is a solar-powered combined rain and sun sensor compatible with Radio Technology Somfy (RTS) motorized exterior products, including awnings, rolling shutters and screens. The sensor uses optical rain-sensing technology to measure rainfall and sends an RTS command when rainfall exceeds the user-selected threshold. It also utilizes a sun-level sensor that sends an RTS command when sunlight exceeds the user-selected threshold.

Somfy Soliris transmitter (not included) is required to activate the motor's sun function.

WARRANTY		5-Year
ITEM #	STYLE #	STANDARD PACKAGE
274421	9019617	1

Somfy® is a registered trademark of Somfy Systems, Inc. Ondeis™ is a trademark of Somfy Systems, Inc.

## Somfy® Eolis Wind Sensor Kit

The Eolis Wind Sensor includes an integrated radio receiver. Wind speed is continuously monitored, triggering the control to retract awnings automatically as needed. The Eolis can operate the controls individually or in groups using Telis Transmitters.

WARRANTY		5-Year		
ITEM #	STYLE #	DESCRIPTION	COLOR	STANDARD PACKAGE
274401	9013847	3D WireFree RTS Wind Sensor	Black	1
274400	1816083	3D WireFree RTS Wind Sensor	Off-White	1
274395	1816081	3D WireFree RTS Wind Sensor	White	1
274275	9012499	RTS Wind Sensor Kit 24V DC		1

Somfy® is a registered trademark of Somfy Systems, Inc.



## Somfy® Soliris Sensor

This radio remote-controlled receiver provides dependable and automatic protection based on sun and wind levels. The Soliris Sensor automatically retracts a motorized awning when it senses high winds and opens in intense sunlight. The Soliris Sensor provides electronic ease and complete climate control, for the ultimate in awning protection and convenience.

Somfy Soliris transmitter (not included) is required to activate the motor's sun function.

WARRANTY		5-Year	
ITEM #	STYLE #	DESCRIPTION	STANDARD PACKAGE
274277	9012500	RTS Wind/Sun Sensor Kit	1

Somfy® is a registered trademark of Somfy Systems, Inc.

## Somfy® Universal RTS Receiver

The Somfy Universal RTS Receiver provides RTS capability to Somfy's standard (non-RTS) motors. It can be used as a stand-alone radio control, or with Somfy's RTS sensor for sun and wind control. One user-defined intermediate stop-position can be programmed. This 110V control is packaged in a weatherproof enclosure and includes watertight strain-relief fittings for wires entering the box.

<b>WARRANTY</b>		5-Year	
ITEM #	STYLE #	DESCRIPTION	STANDARD PACKAGE
274510	1810627	Universal RTS Receiver	1

Somfy® is a registered trademark of Somfy Systems, Inc.

## Somfy® myLink™

The myLink™ RTS Smartphone and Tablet Interface is a WiFi to Radio Technology Somfy® bridge that can control up to 5 channels of RTS motorized products using the Somfy myLink apps for iOS and Android devices. Through the app, users can send immediate RTS commands, create Scenes (a group of motorized products working together) and Schedules (timed events). Users may access their myLinks from anywhere with the app's remote access feature. Though the myLink is a single-zone controller, multiple myLinks can be joined within the same system for multi-zone control.

<b>WARRANTY</b>		5-Year
ITEM #	STYLE #	STANDARD PACKAGE
270400	1811403	1

Somfy® is a registered trademark of Somfy Systems, Inc. myLink™ is a trademark of Somfy Systems, Inc.

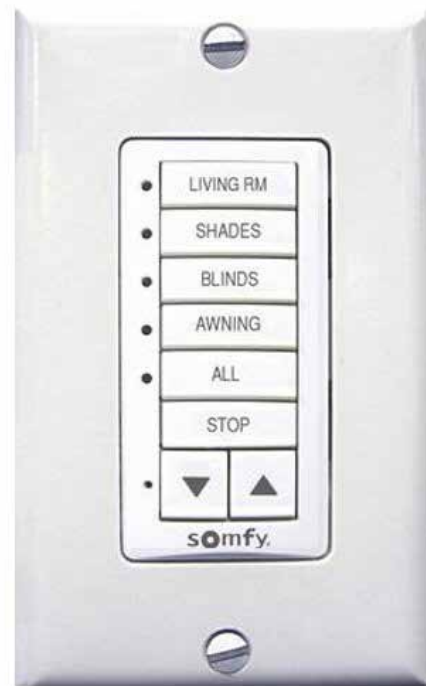

## DecoFlex WireFree™ RTS

The DecoFlex WireFree RTS battery powered wall switch features Radio Technology Somfy (RTS) and may be personalized for intuitive control of window coverings such as shades, blinds, draperies, rolling shutters and awnings. It is available fully assembled in one and five channel button versions or may be easily converted to a two, three or four channel button switch. Choose from three colors – white, ivory or black – to match any decor. The switch is designed to complement the full range of Somfy RTS handheld transmitters, timers and interfaces.

Installation is quick and simple, with no wiring required. Included with each switch is an extended life lithium battery eliminating the need for an electrician. The DecoFlex WireFree RTS may be installed independently or next to an existing light switch using the included wall mounting bracket and the appropriate wall plate.

<b>WARRANTY</b>		5-Year		
ITEM #	STYLE #	DESCRIPTION	COLOR	STANDARD PACKAGE
275105	1810898	1-Channel WireFree RTS	Ivory	1
275104	1810897	1-Channel WireFree RTS	White	1
274991	61114025	2-Channel Face Plate	Ivory	1
274990	61114024	2-Channel Face Plate	White	1
274994	61114034	3-Channel Face Plate	Ivory	1
274993	61114033	3-Channel Face Plate	White	1
274997	61114044	4-Channel Face Plate	Ivory	1
274996	61114043	4-Channel Face Plate	White	1
275107	1810814	5-Channel WireFree RTS	Ivory	1
275106	1810813	5-Channel WireFree RTS	White	1

Somfy® is a registered trademark of Somfy Systems, Inc.





## Somfy® Infrared Heater

The new Somfy Infrared Heater with RTS receiver is a 1500 watt heater that enables your customers to spend more time enjoying their awning and outdoor living space. Equipped with Somfy's exclusive RTS technology, users can control the heater with the same remote they use to control their awning. This weatherproof infrared heater is environmentally friendly and energy efficient by providing instant heat to warm people, not the air, and has a lower running cost than gas heaters. Provides heat up to 1300 square feet (13 feet x 10 feet) or approximately an area equivalent to a table with five chairs.

<b>WARRANTY</b>	5-Year
-----------------	--------

ITEM #	STYLE #	DESCRIPTION	COLOR	STANDARD PACKAGE
273902	1824018	RTS 1500-Watt Infrared Heater	White	1
273903	9015148	RTS Heater Mounting Bracket		1

Somfy® is a registered trademark of Somfy Systems, Inc.

Shade Inspiration Collection™ Sales MaterialsShade Inspiration Collection™ Sales Materials

For ordering assistance, contact Trivantage customer service at 800.786.1876 or visit the online Solair Shade Solutions Extranet for order forms and pricing.

## RollEase® Roller Shade System

Patented, manually operated clutch mechanism. Easy to fabricate and install. Clutch automatically locks, holding shade securely in place. Adjacent shades are easily set to matching levels. Shades stay clean, you never have to touch the fabric.

Not intended for outdoor applications.

ITEM #	DESCRIPTION	COLOR	DIAMETER	LENGTH	MATERIAL	SIZE	STANDARD PACKAGE
224521	Chain Stop Ball					5/16 in.	100
224514	Clutch R-16	Black	1-1/2 in.				1
224516	Clutch R-16	Vanilla	1-1/2 in.				1
224598	Clutch R-16	White	1.5 in.				1
224517	Clutch R-24	Vanilla	1-1/2 in.				1
224518	Clutch R-8	Black	1-1/2 in.				1
224555	Clutch R-8	Black	1-1/4 in.				1
224515	Clutch R-8	Vanilla	1-1/4 in.				1
224519	Clutch R-C14	Vanilla	1-1/2 in.				1
224591	Clutch/End Plug Conversion Adapter	Black				1-1/2 in. to 2 in.	1
224592	Clutch/End Plug Conversion Adapter	Vanilla				1-1/2 in. to 2 in.	1
224486	End Plug		1-1/2 in.				1
224512	End Plug	Black	1-1/2 in.				1
224556	End Plug	Black	1-1/4 in.				1
224511	End Plug	Vanilla	1-1/2 in.				1
224510	End Plug	Vanilla	1-1/4 in.				1
224547	Exterior Clutch R-24	Black	1-1/2 in.				1
224620	Exterior Clutch R-8	Vanilla	1.5 in.				1
224587	Exterior Hem Bar	Anodized Aluminum		12 ft.			288
224645	Exterior Hem Bar	Anodized Aluminum		16 ft.			160
224589	Exterior Hem Bar	Black		12 ft.			288
224646	Exterior Hem Bar	Black		16 ft.			160
224586	Exterior Hem Bar	Dark Bronze		12 ft.			288
224644	Exterior Hem Bar	Dark Bronze		16 ft.			160
224584	Exterior Hem Bar	Vanilla		12 ft.			288
224642	Exterior Hem Bar	Vanilla		16 ft.			160
224585	Exterior Hem Bar	White		12 ft.			288
224643	Exterior Hem Bar	White		16 ft.			160
224580	External Hem Bar Strip			300 ft.			1
224574	Fascia Bracket for R-16 Clutch	Black				3 in.	1
224570	Fascia Bracket for R-16 Clutch	Bronze				3 in.	1
224571	Fascia Bracket for R-16 Clutch	Vanilla				3 in.	1
224572	Fascia Bracket for R-16 Clutch	White				3 in.	1
224577	Fascia Bracket for R-24 Clutch	Bronze				4 in.	1
224564	Fascia Bracket for R-24 Clutch	Vanilla				4 in.	1
224576	Fascia Bracket for R-24 Clutch	White				4 in.	1
224560	Fascia Bracket for R-8 Clutch	Bronze				3 in.	1
224561	Fascia Bracket for R-8 Clutch	Vanilla				3 in.	1
224562	Fascia Bracket for R-8 Clutch	White				3 in.	1
224553	Fascia	Anodized Aluminum				3 in. x 12 ft.	12
224528	Fascia	Anodized Aluminum				3 in. x 16 ft.	10
224566	Fascia	Anodized Aluminum				4 in. x 12 ft.	12
224632	Fascia	Anodized Aluminum				4 in. x 16 ft.	1
224554	Fascia	Black				3 in. x 12 ft.	12
224558	Fascia	Black				3 in. x 16 ft.	12

ITEM #	DESCRIPTION	COLOR	DIAMETER	LENGTH	MATERIAL	SIZE	STANDARD PACKAGE
224565	Fascia	Black				4 in. x 12 ft.	12
224631	Fascia	Black				4 in. x 16 ft.	12
224550	Fascia	Bronze				3 in. x 12 ft.	12
224500	Fascia	Bronze				3 in. x 16 ft.	16
224568	Fascia	Bronze				4 in. x 12 ft.	12
224640	Fascia	Bronze				4 in. x 16 ft.	1
224551	Fascia	Vanilla				3 in. x 12 ft.	12
224501	Fascia	Vanilla				3 in. x 16 ft.	10
224569	Fascia	Vanilla				4 in. x 12 ft.	12
224641	Fascia	Vanilla				4 in. x 16 ft.	1
224552	Fascia	White				3 in. x 12 ft.	12
224508	Fascia	White				3 in. x 16 ft.	10
224567	Fascia	White				4 in. x 12 ft.	12
224633	Fascia	White				4 in. x 16 ft.	1
224582	Hem Bar End Cap with Screw	Black					100
224588	Hem Bar End Cap with Screw	Vanilla					100
224581	Hem Bar End Cap with Screw	White					100
224648	Interior Clutch R-24	Black	1.5 in.				1
224686	Internal Hem Bar			16 ft.			16
224544	Metal Chain Connector						1
224525	Metal Chain with Safety Warning Tag			4 ft.			1
224526	Metal Chain with Safety Warning Tag			5 ft.			1
224527	Metal Chain with Safety Warning Tag			6 ft.			1
224520	Metal Chain with Safety Warning Tags			500 ft.			1
224507	Mounting Bracket Cover for R-8 Clutch	White					1
224506	Mounting Bracket for R-16 Clutch 1-1/2 in.				Nickel		1
224524	Mounting Bracket for R-16, R-24 Clutch 2 in.				Nickel		1
224505	Mounting Bracket for R-3, R-8 Clutch 1-1/2 in.				Nickel		1
224509	Mounting Bracket for R-3, R-8 Clutch 2 in.				Nickel		1
224541	Plastic Chain Connector	Black					100
224539	Plastic Chain Connector	Clear					100
224542	Plastic Chain Connector	Vanilla					100
224540	Plastic Chain Connector	White					100
224531	Plastic Chain with Safety Warning Tags	Black		100 ft.			1
224536	Plastic Chain with Safety Warning Tags	Black		820 ft.			1
224533	Plastic Chain with Safety Warning Tags	Brown		820 ft.			1
224532	Plastic Chain with Safety Warning Tags	Vanilla		100 ft.			1
224537	Plastic Chain with Safety Warning Tags	Vanilla		820 ft.			1
224530	Plastic Chain with Safety Warning Tags	White		100 ft.			1
224535	Plastic Chain with Safety Warning Tags	White		820 ft.			1
224634	Plastic Chain	Vanilla		820 ft.			1
224504	Roller Tube Taped				Aluminum	1-1/2 in. x 12 ft.	96
224503	Roller Tube Taped				Aluminum	1-1/4 in. x 12 ft.	120
224627	Roller Tube Taped				Aluminum	2 in. x 12 ft.	48
224628	Roller Tube Taped				Aluminum	2 in. x 16 ft.	64
224649	SafetyHold3	Clear					1

RollEase® is a registered trademark of RollEase, Inc.

RollEase Roller Shade – Selecting Clutch and Tube Sizes

Shade Height (In.)

Fabric Weight (Oz. Per Yd.)

18 Oz. 12 Oz. 6 Oz.

Shade Width (In.)

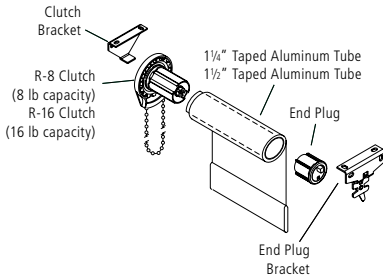
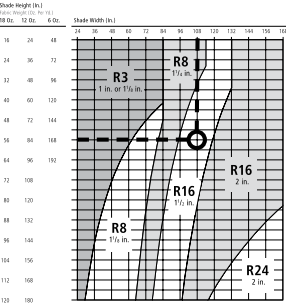
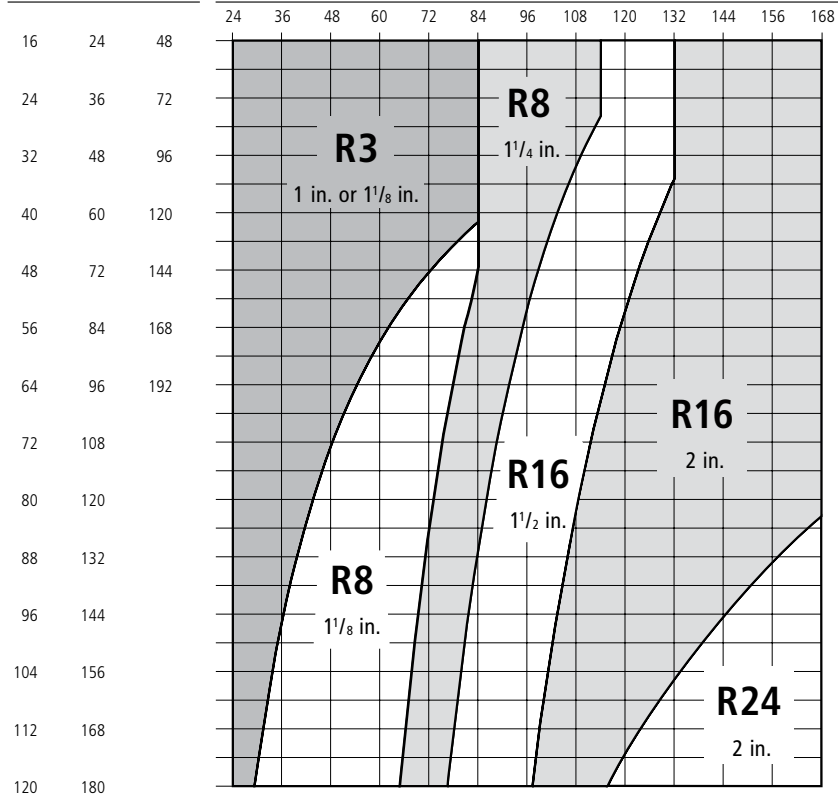

1. IN THE LEFT HALF OF THE CHART, find the column appropriate for the shade's fabric. Read down that column until you reach the approximate height of the shade.
2. FOLLOW STRAIGHT ACROSS to the right half of the chart, as far as the vertical line that represents the shade's width.
3. THE CLUTCH AND TUBE SIZES SHOWN ARE THE MINIMUM you may use for that shade. You may, of course, use a heavier clutch or a larger tube. But using a lighter clutch might lead to clutch failure. Using a smaller tube might lead to bowing of the tube.

**Example:** What is the smallest clutch-and-tube combination for a 12 oz. shade that is 100 in. wide and 84 in. tall? The arrows (in the small chart below) that start from height = 84 in. and width = 100 in. show this to be an R16 clutch in 1 1/2 in. tube

For ordering assistance, contact Trivantage customer service at 800.786.1876 or visit the online Solair Shade Solutions Extranet for order forms and pricing.

## Somfy® Motors and Accessories for Interior Shades – R28 Motor

The Somfy® R28 motor is the perfect solution for hard-to-reach window coverings. Designed for roller/solar shades, sheer horizontals, Roman and woven wood shades. Battery powered. Installs in minutes.

<b>WARRANTY</b>	5-Year
-----------------	--------

ITEM #	STYLE #	DESCRIPTION	STANDARD PACKAGE
276715	9018475	Crown for 1-1/2 in. RollEase Tube	1
276596	9018474	Crown for 1-1/4 in. RollEase Tube	1
276716	9018477	Drive for 1-1/2 in. RollEase Tube	1
276597	9018476	Drive for 1-1/4 in. RollEase Tube	1
276593	1002481	RTS Motor R28-12v	1
276713	9019235	Solar Pack WireFree Kit with Battery Pack	1

RollEase® is a registered trademark of RollEase, Inc. Somfy® is a registered trademark of Somfy Systems, Inc.



274344

## Somfy® Motors and Accessories for Interior Shades

Motorization for 1-1/4 inch and 1-1/2 inch RollEase® Roller Tube. Deductions for motorized operation are 1-1/8 inches.

<b>WARRANTY</b>	5-Year
-----------------	--------

ITEM #	STYLE #	DESCRIPTION	STANDARD PACKAGE
274344	9013488	1-1/2 in. Crown and Drive Set	1
270597	1781148	Aluminum Roller Tube 2 in. x 20 ft.	100
275064	1030066	Sonesse RH RTS Motor 504S2	1
275063	1030065	Sonesse RTS Motor 504S2 with Hardwire Cable	1
274546	1810647	Telis Soliris RTS Patio Transmitter	1
274799	1822192	Transformer Plug-In 12v DC with 25 ft. Cable	1
276675	9016374	Y-Harness Extension Cable 2 ft.	1

RollEase® is a registered trademark of RollEase, Inc. Somfy® is a registered trademark of Somfy Systems, Inc.



276604

## Somfy® Motors and Accessories for Interior Shades – ST30 Motor

Motorization for 1-1/2 inch RollEase® Roller Tube using Somfy ST30 Sonesse Motor. Deductions for motorized operation are 1-1/8 inches.

<b>WARRANTY</b>	5-Year
-----------------	--------

ITEM #	STYLE #	DESCRIPTION	STANDARD PACKAGE
276619	9013775	Crown and Drive Set 1-1/2 in.	1
276604	1822209	Transformer 24v 1.25A DC Wall Mount Plug-In with 10 ft. Cable	1

RollEase® is a registered trademark of RollEase, Inc. Somfy® is a registered trademark of Somfy Systems, Inc.

## Somfy® Home Automation

<b>WARRANTY</b>	5-Year
-----------------	--------

ITEM #	STYLE #	DESCRIPTION	STANDARD PACKAGE
275033	1810791	RTS Repeater and Range Expander 120VAC 60Hz	1
275032	1810872	Universal RTS Interface II 16-Channel	1

Somfy® is a registered trademark of Somfy Systems, Inc.